



LED WORK LIGHT WITH TRIPOD PAS 1500 LM A1

GB IE NI

LED WORK LIGHT WITH TRIPOD

Operating and safety information

IAN 366811_2010

IE NI

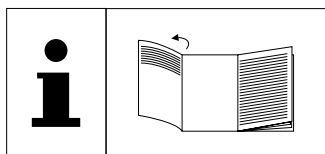

GB **IE** **NI**

Before you start reading, please fold out the illustrations page and familiarise yourself with all of the item's functions.

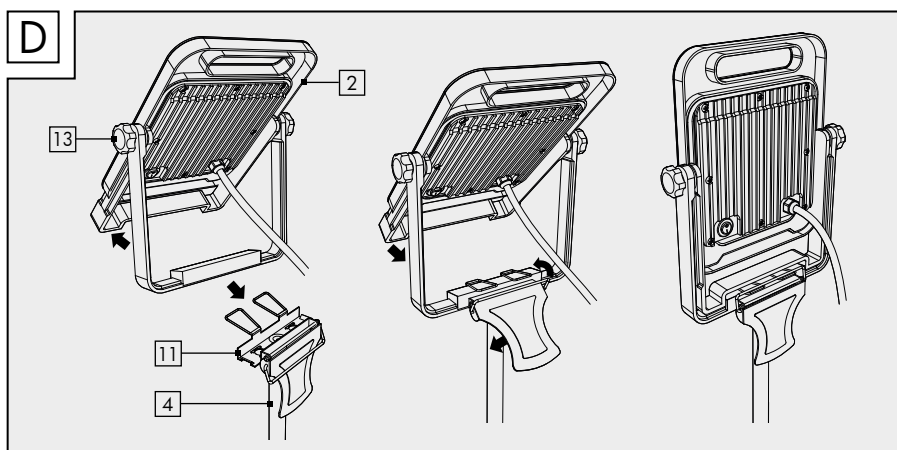
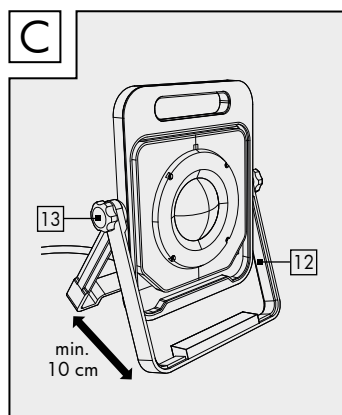
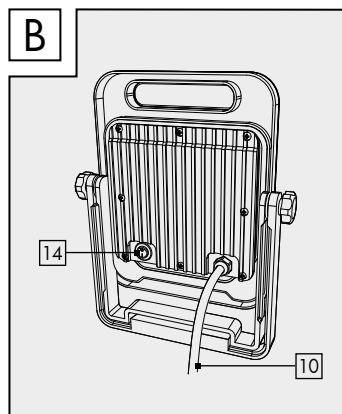
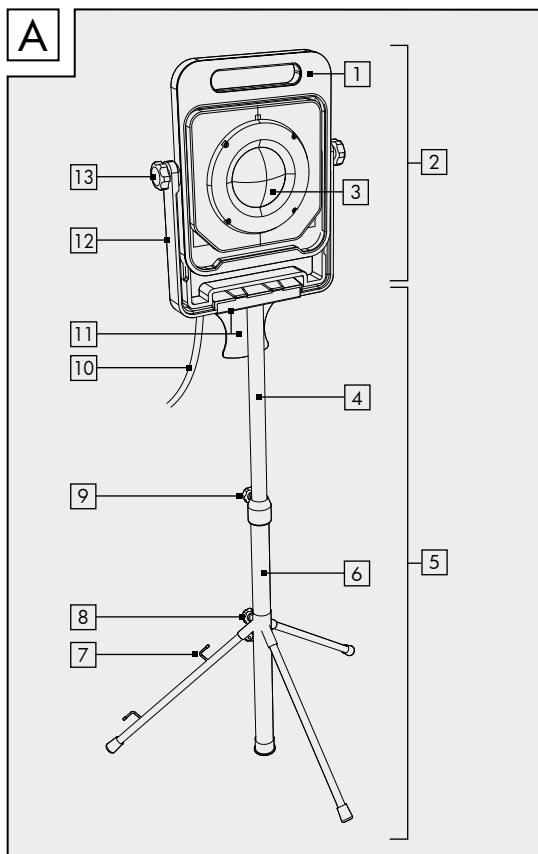

Introduction	6
Explanation of symbols	6
Intended use	7
Specifications supplied	7
Description of parts	7
Technical data	7
Safety instructions	8
Assembly	9
Setting up the tripod stand	9
Setting the height of the tripod stand	9
Mounting the work floodlight on the tripod stand	9
Operation without tripod stand	9
Switching on/off	10
Cleaning	10
Disposal	10
Warranty	10
Service	11

LED Work Floodlight with Stand

● Introduction



Congratulations on the purchase of your new appliance. You have chosen a high-quality product. Please read these operating instructions thoroughly and carefully. These instructions are an essential part of the product and contain important information on first-time use and handling. Always observe all safety instructions. If you have any questions or are unsure how to operate the appliance, please contact your retailer or service centre. Please keep this manual in a safe place and pass it on to third parties where necessary. In the remainder of this document, the product is referred to as “the floodlight”.

● Explanation of symbols



Read the operating instructions!



Date of manufacture (month/year)



Alternating current



Observe warning notices and safety instructions!



Risk of fatal injury and accidents for infants and children!



Caution! Risk of skin burns from hot surfaces!



Warning! Risk of electric shock!



Dispose of packaging and product in an environmentally friendly manner!



Not suitable for indoor lighting



Lamp suitable for rugged use



Cable length

IP65



(Floodlight)

Protected against ingress of dust (dust-proof, fully contact-proof) and sprayed water from any direction.

IP44

(Mains plug)

Protected against solid foreign objects with a diameter of ≥ 1.0 mm, splash-proof



Protection class I: the user and third parties are protected against electric shock by a protective earth (PE) conductor.

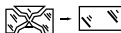

Any protective cover that is cracked or split must be replaced. If the floodlight is damaged in any way, stop using it immediately and contact the service address indicated below.



Packaging made of FSC-certified wood mix



The “GS” symbol stands for safety-tested. Products that are marked with this symbol meet the requirements of the German Product Safety Act (Produktsicherheitsgesetz).



With the CE label, the manufacturer confirms that this electrical device complies with the applicable European directives.

● Intended use

This floodlight is suitable for rugged use indoors and outdoors. The floodlight is not intended for use as a hand-held lamp. The handle is intended for moving the position of the floodlight. The floodlight must not be connected to the power supply while it is being moved. The lamp can withstand extremely high levels of physical stress in the form of shocks ($1 \text{ m}^2/\text{s}^3$, 200 - 2,000 Hz). This product is intended for use in private households only. Any type of use other than that described above or any modification of the product is prohibited and likely to cause damage. The manufacturer accepts no liability whatsoever for damage of any kind resulting from use of the product other than as intended. The product is not intended for commercial use. The product is not suitable for general indoor lighting in the home.

● Specifications supplied

- 1 work floodlight
- 1 tripod stand
(telescopic pole and tripod base)
- 1 instruction manual

● Description of parts

- 1 Handle
- 2 Floodlight
- 3 LED module
- 4 Telescopic pole
- 5 Tripod stand
- 6 Tripod base
- 7 Cable hook
- 8 Hand screw (tripod base)
- 9 Hand screw (telescopic pole)
- 10 Mains power cable
- 11 Mounting clamp
- 12 Folding bracket

13 Hand screw (folding bracket)

14 ON/OFF switch

● Technical data

Power supply voltage:	220-240 V AC, 50 Hz
Light source:	LED module (non-user replaceable)
Power consumption:	20 W
Luminous power:	1,500 lm with diffusor, 2,000 lm without diffusor
Colour temperature:	6,500 K (cold white)
Max. stand height:	1.54 m
Protection rating	IP65 (proof against sprayed water)
Protection class:	I
Cable length:	5 m
LED service life:	approx. 30,000 h
Beam width:	approx. 90°
Max. projection area:	40 cm ²
Colour reproduction:	RA > 80
Minimum tilt angle (floodlight):	50°
Dimensions:	27.5 x 23 x 6.5 cm (height including stand 1.54 m)
Model number:	1006-AS-UK

● **Safety instructions**



Safety instructions



⚠ WARNING!

RISK OF FATAL INJURY AND ACCIDENTS FOR INFANTS AND

CHILDREN! Never leave children unsupervised with the packaging material. There is a danger of suffocation from the packaging material. Children often underestimate the dangers. Always keep children away from the product.

- This product can be used by children aged 8 years and over, as well as by persons with limited physical, sensory or mental abilities or lacking in experience and knowledge if they have been supervised and instructed as to the safe use of the product and understand the resulting hazards. Do not let children play with the product. Cleaning and maintenance may not be carried out by children without proper supervision.
- Do not use the product if you notice any damage.
- The light source contained in this luminaire shall only be replaced by the manufacturer or his service agent or a similar qualified person.
- The mains power cable  of this product cannot be replaced; if the power cable is damaged, the product must be disposed of.
- Never carry the product by the mains power cable.
- Always route the mains power cable in such a way that nobody can tread on it or trip over it.



AVOID THE RISK OF FATAL INJURY FROM ELECTRIC SHOCK!

- Always check the product for any damage before connecting it to the mains power supply. Never use the product if it has any signs of damage.

- Protect the mains power cable from sharp edges, mechanical stress and hot surfaces.
- When connecting or disconnecting the cable to/from the power supply, only hold the insulated part of the mains plug!
- Always unplug the mains power cable before assembling, dismantling or cleaning the product.
- Always disconnect the product from the mains power supply if it is not going to be used for an extended period (e.g. holiday) or if you want to set it up in a different place.
- Never open up any of the electrical components or insert any objects in them. Doing so would risk fatal injury from electric shock.
- Before using the product, make sure that the mains power supply voltage matches the supply voltage required by the product (220-240 VAC, 50 Hz).



AVOID THE RISK OF FIRE AND INJURY!



RISK OF BURNS FROM HOT SURFACES!

- To avoid the risk of burns, make sure that the product is switched off and has cooled down before you touch it. Light sources generate a large amount of heat.
- Do not cover over the product with other objects. Excessive heat build-up can cause a fire.
- Do not leave the product unattended while in use. Excessive heat build-up can cause a fire.
- The LED module is not dimmable.
- Never look directly into the light source (light bulb, LED, etc.). Never look at the light source (light bulb, LED, etc.) through an optical instrument (e.g. magnifying glass).
- Any protective cover that is split or cracked must be replaced.
- Never direct the LED light beam at reflective surfaces or towards people or animals.

Failure to follow the above instruction may cause people or animals to suffer eye injuries and/or to lose their sight. Even a weak LED light beam is capable of causing eye damage.

● Assembly

Please note: remove all packaging material from the product. Protect easily damaged surfaces before setting up the product.

Please note: fully unwind the mains power cable. Route the mains power cable in such a way that nobody can tread on it or trip over it.

● Setting up the tripod stand

- ☐ Loosen the hand screw (tripod base) [8] by turning it anticlockwise.

RISK OF TRAPPING/PINCHING! To avoid injuries when unfolding the legs, take care not to put your hands between the tripod base and the legs.

- ☐ Take hold of the tripod base [6] at the point where the legs are attached, level with the hand screw (tripod base) [8], and press it downwards so that the legs fold out. Once the tripod base [6] is pushed down as far as it will go and the legs are fully extended, re-tighten the hand screw (tripod base) [8] by turning it clockwise (see Fig. A).

● Setting the height of the tripod stand

- ☐ Loosen the hand screw (telescopic pole) [9] by turning it anticlockwise (see Fig. A).
- ☐ Set the tripod stand [5] to the desired height by pulling up or pushing down the telescopic pole [4] (see Fig. A).
- ☐ Firmly tighten the hand screw (telescopic pole) [9] by turning it clockwise to fix the tripod stand [5] at the desired height (see Fig. A).

● Mounting the work floodlight on the tripod stand



RISK OF ELECTRIC SHOCK!

Unplug the mains plug from the power outlet socket before mounting the floodlight on the tripod stand.

- ☐ Open the mounting clamp [11] at the top of the telescopic pole [4] so that the locking handle is facing towards you (see Fig. D).
- ☐ Loosen the hand screw (folding bracket) [13] so that you can fold the floodlight and the inner bracket to the rear out of the way. Then locate the floodlight [2] centrally on the open mounting clamp [11] with the aid of the handle [1] (see Fig. D).

Please note: make sure that the back of the floodlight is facing the locking handle. Otherwise it is not possible to close the mounting clamp.

Please note: take care to ensure the mains power cable is not trapped.

- ☐ Fold down the two rear clips of the mounting clamp over the outer folding bracket of the floodlight, which is now seated in the mounting clamp (see Fig. D). Next, fold down the front clip of the mounting clamp over the two rear clips previously folded down, so that they interlock (see Fig. D).
- ☐ Press down the locking handle of the mounting clamp [11] to fix the mounting bracket in place (see Fig. D).
- ☐ Now position the floodlight and inner folding bracket centrally over the mounting clamp and fix them in position by tightening the hand screw [13] (see Fig. D).

● Operation without tripod stand



RISK OF ELECTRIC SHOCK!

Unplug the mains plug from the power outlet socket before attempting to alter the position of the

floodlight.

- ☐ Remove the floodlight [2] from the tripod stand [5] by releasing the mounting clamp [11] (see Fig. D).
- ☐ Loosen the hand screw (folding bracket) [13] on the side of the floodlight by turning it anticlockwise and unfold the folding bracket [12] (see Fig. C).
- ☐ To provide a stable base, fold out the folding brackets [12] so that they are at least 10 cm apart (see Fig. C).
- ☐ Fix them in position by tightening the hand-screw (folding bracket) [13] on the floodlight.
- ☐ Position the floodlight as desired.

● Switching on/off

- ☐ Plug the mains power cable [10] into a properly installed power outlet socket.

Please note: to ensure full protection against splash-water, plug the mains power cable into an IPX4-rated power outlet socket.

- ☐ Push the ON/OFF switch [14] to position "I" to switch the floodlight on. Push the ON/OFF switch to position "O" to switch it off again (see Fig B).

● Cleaning

-  **RISK OF ELECTRIC SHOCK!** Always unplug the mains power cable from the socket before cleaning the product.

- For reasons of electrical safety, the product must never be cleaned with abrasive cleaning agents or immersed in water.

-  **RISK OF BURNS FROM HOT SURFACES!** Allow the product to cool down completely.

- Do not use any solvents, petrol or the like. Doing so would damage the product.
- ☐ Use only a dry, lint-free cloth for cleaning. If the product is very dirty, dampen the cloth slightly.

● Disposal



Note the labels on the packaging materials when sorting the waste; they are marked with abbreviations (a) and numbers (b) with the following meanings:

1 - 7: Plastics

20 - 22: Paper and cardboard

80 - 98: Composite materials



You can find out how to dispose of the used product by contacting your local district or city council.



In the interest of environmental protection, when the product has reached the end of its useful life, do not dispose of it as general household waste but have it properly recycled. For information on recycling centres and their opening times, please contact your local council.

● Warranty

Dear customer, This product comes with a 3-year warranty from the date of purchase. In the event that this product is faulty, you have legal rights against the seller of the product. These statutory rights are not restricted by our warranty as set out below.

Warranty terms

The warranty period begins with the date of purchase. Please keep the original receipt in a safe place. It is required as proof of purchase. If a material or manufacturing defect occurs within three years of the date of purchase, we will repair or replace the product for you free of charge, or refund the purchase price, at our discretion. This warranty service is granted provided that the faulty device and the proof of purchase (receipt) are presented within three years, along with a brief written description of the fault and of when it occurred. If the fault is

covered by our warranty, we will return the fixed product or send you a new one. No new warranty period shall begin upon repair or replacement of the product.

Warranty period and statutory warranty claims

The warranty period is not renewed after a warranty service has been granted. This rule shall also apply for any replaced or repaired parts. Any damage or faults that already existed when buying the product must be reported immediately upon unpacking the product. A fee is charged for any repairs that are carried out after the end of the warranty period.

Warranty scope

The device was carefully manufactured according to the strictest quality guidelines and thoroughly tested before delivery. The warranty applies to material or manufacturing defects. This warranty does not apply to product parts that are subject to normal wear and tear and can therefore be regarded as wearing parts, or damage to fragile parts, such as switches, rechargeable batteries or parts that are made of glass. This warranty is void if the product has been damaged, improperly used or serviced. To ensure proper use, all instructions included in the manual must be followed carefully. All uses and actions that users are discouraged from or warned of in the manual must be avoided under all circumstances. The product is intended for private household use only, and not for commercial activities. The warranty is void, if the product is treated inappropriately, if force is applied, and in the case of any manipulation that is not carried out by our authorised service branch.

Warranty processing

To ensure your request is handled swiftly, please observe the following

Notes:

- ☐ Please have the receipt and the article number (e.g. IAN 123456) ready as proof of purchase for all enquiries.
- ☐ Please refer to the type plate on the product, an engraving on the product, the cover of the manual (bottom left) or the sticker on the back or base of the product to find out the product number.
- ☐ In the case of any malfunctions or other defects, please call or email the service department indicated below as a first step.
- ☐ After your product has been registered as faulty, you can send it to the specified service address, free of charge. Please include the proof of purchase (receipt) and information about the defect and about when it occurred.

● Service



Service Great Britain
Tel.: 00800 80040044
E-Mail: administration@mynetsend.de



Service Ireland
Tel. : 00800 80040044
E-Mail: administration@mynetsend.de

IAN 366811_2010

Please have the receipt and the article number (e.g. IAN 123456) ready as proof of purchase for all enquiries.

You can find an up-to-date version of the operating instructions at: www.citygate24.de



citygate24 GmbH

Lange Mühren 1
20095 Hamburg
GERMANY

 03/2021

Model No.: 1006-AS-UK

IAN 366811_2010

